



CP-6

Wireless conference speakerphone

Omnidirectional pickup + wireless cascading

Eclipse CP6 integrates eight professional omnidirectional microphones with 3A intelligent audio algorithms, working in unison to create a precise 360° sound field. This system captures every voice clearly within a 5-10 meter radius. It delivers natural, high-fidelity sound through its built-in speaker and connects instantly wirelessly or by USB cable. The wireless cascade function allows for effortless expansion to adapt to medium and large meeting spaces. Fully compatible with major platforms, the CP6 turns audio into an invisible, reliable foundation for seamless collaboration, locally or across borders.



Nedo Pakistan
Leading IT Company

KARACHI | LAHORE | ISLAMABAD

www.nedopakistan.com
UAN : 021-111-633-675



Wireless cascading



Microphone array



Hi-fi Speaker



Echo cancellation



DSP audio processing



6000mAh battery



Bluetooth



Plug and play

Product Highlights



Wireless Cascading

Supports wireless daisy chaining of two units to expand the voice pickup range and power, while ensuring a neat and tidy desk.



Microphone Array

Built-in 8 microphones for 360° omnidirectional pickup. When two units cascade, it enables simultaneous amplification and audio capture, expanding both pickup and playback range.



3A Audio Processing

Built-in AI audio processing algorithms, including source separation (SSP), reverb suppression (De-Rev), intelligent noise reduction (ANS), and automatic gain control, to ensure the voice is real and clear even in a noisy environment.



Hi-Fi speaker

Built-in hi-fi speaker with excellent bass effect. When cascading, the speaker's power will be doubled.



Long Battery Life

Built-in 6000mAh lithium battery, offering up to 10 hours of playback for clear, smooth, and stable audio and video experience.



Versatile Connectivity

It supports connection via Bluetooth, a wireless USB dongle, or a USB cable, enabling easy connection for various occasions.

Compatible Software:



Microsoft Teams



Google Voice



Slack



Webex



DingTalk



Facetime



GoTo Meeting



HUAWEI



Trello



CISCO



Telegram

Product View

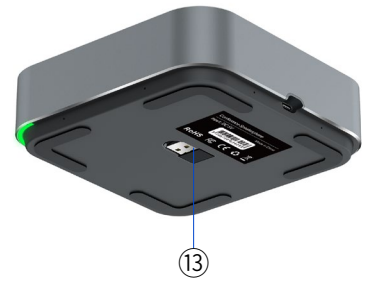
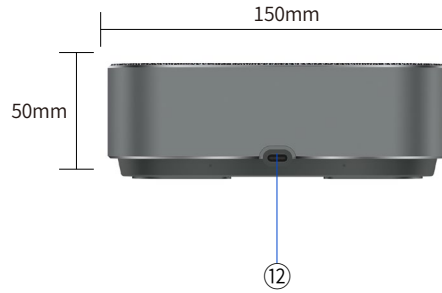
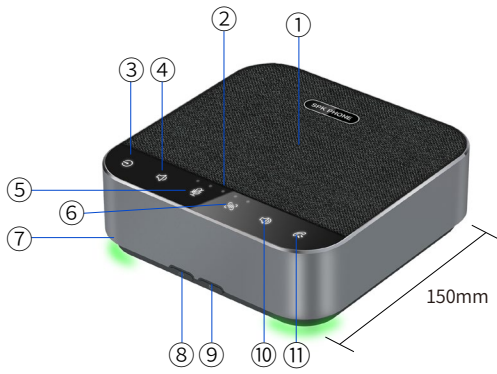

- ① Speaker
- ② LED indicator light
- ③ Bluetooth
- ④ Volume -
- ⑤ Mute/unmute
- ⑥ AI algorithm
- ⑦ Status light
- ⑧ Cascade
- ⑨ Power on/off
- ⑩ Volume +
- ⑪ Answer/end call
- ⑫ Type-C Port
- ⑬ Wireless receiver

Connection Diagram

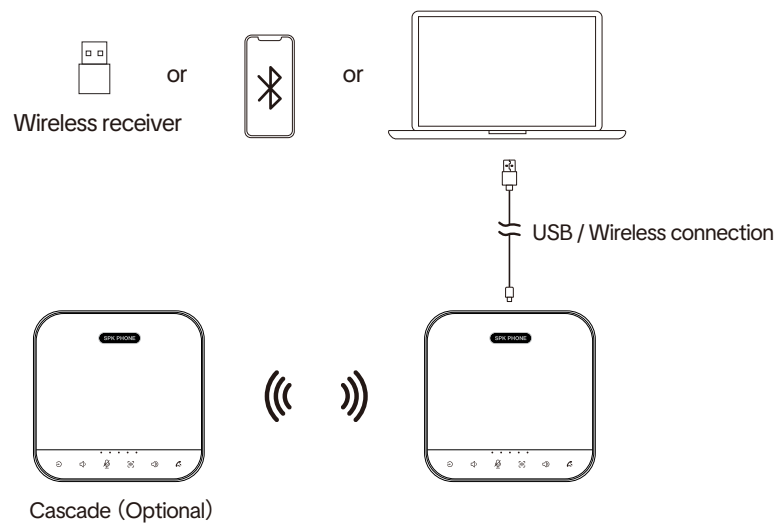

Specifications

ECLIPSE CP6

Microphone array

- Built-in 8 microphone array
- Voice pick up range: radius 5m
- Cascade coverage: 50sqm+

Speaker

- Hi-fi speaker with bass effect
- Double power when cascade

AI Audio Algorithm

- Ai Acoustic echo cancellation and noise reduction
- Dynamic speech enhancement

Other

- Charging: DC 5V
- Battery: 6000mAh
- Warranty: 12 Months
- Product size: 150 x 150 x 50mm
- Package size: 188 x 171 x 87mm

What's In The Box

- 1 x CP6 Speakerphone
- 1 x 1.5meters Type-C cable
- 1 x Wireless Receiver (Optional)
- 1 x User Manual



Nedo Pakistan
Leading IT Company

KARACHI | LAHORE | ISLAMABAD

www.nedopakistan.com
UAN : 021-111-633-675